

**Switch – De-activator – Pedal (Clutch) – Remove and Install (33 502 0)****Remove**

1. **Detach the driver's side lower crash pad/facia panel (five screws).**

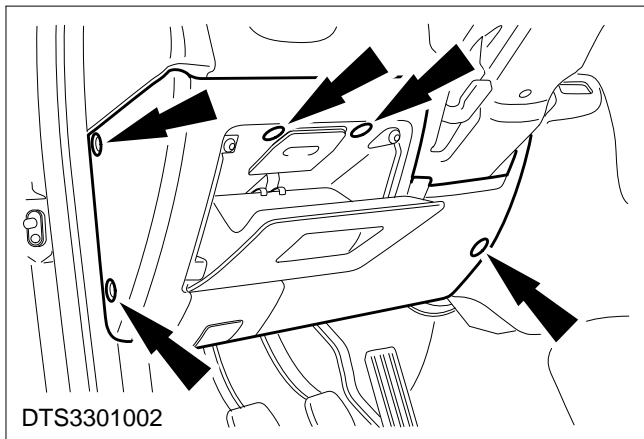
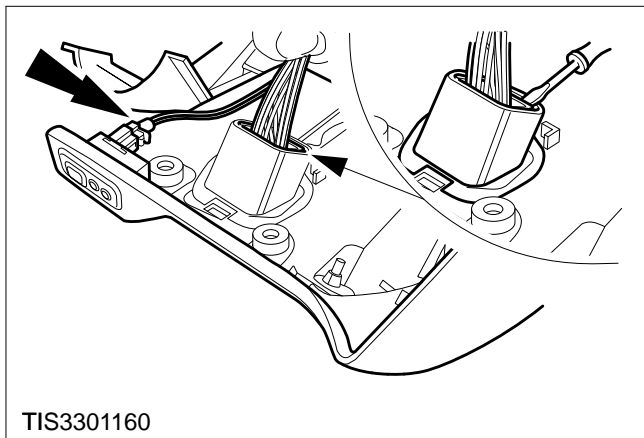

**NOTE:** There is no need to disconnect the hood release cable.

2. **Detach the driver's side lower crash pad/facia panel (continued).**
  - Disconnect the trip computer switch multiplug (if fitted).
  - Detach the data link connector and lower the panel.

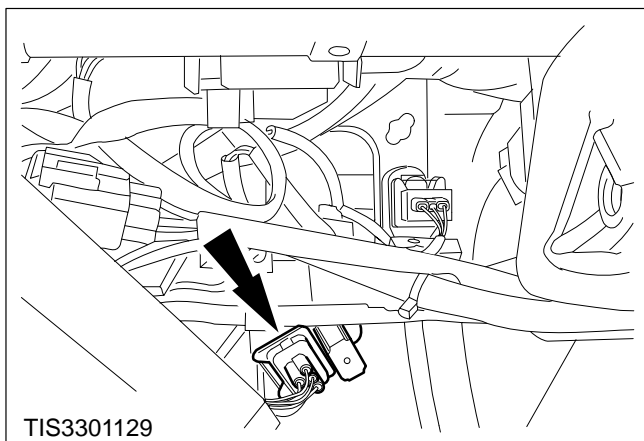

3. **Disconnect the multiplug.**

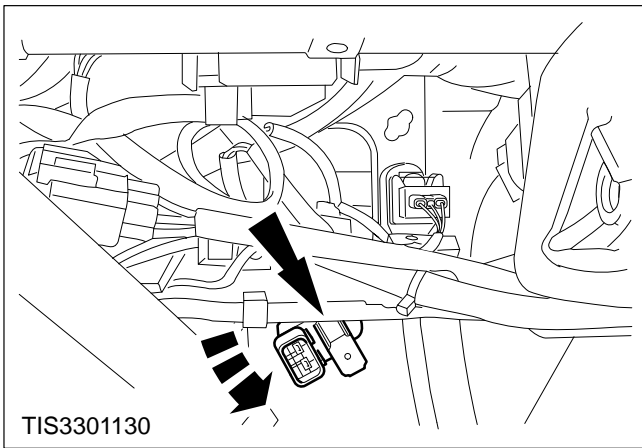
**4. Remove the de-activator switch.**

Twist the switch anticlockwise to remove.

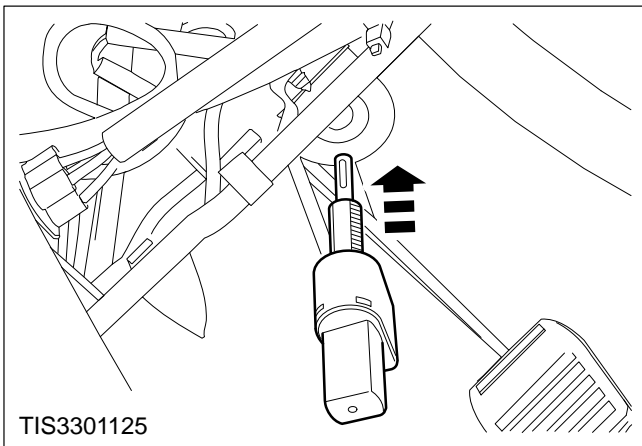
**Install****5. Refit the switch.**

- Insert the switch into the locating slot.
- Hold the clutch pedal in the rest position.
- Push the switch down until the plunger is fully in and turn clockwise to lock in position.

**6. Refit the remaining components in reverse order.**