

Sender Unit – Temperature (except DOHC 16V) – Remove and Install (33 306 0)

Remove

⚠ CAUTION: When releasing the cooling system pressure, cover the cap with a thick cloth to prevent scalding.

1. Slowly relieve the cooling system pressure by rotating the expansion tank cap through 90°.

2. Re-tighten the cap.

3. Remove the sender unit (DOHC 8V variant shown).

1 Pull off the wiring connector.

2 Unscrew and remove the sender unit.

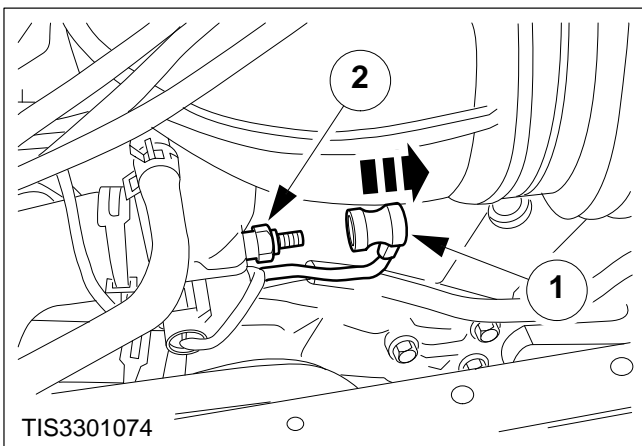

Install

4. Refit the components in reverse order.

Top up the coolant if necessary.

