



Module – Passenger Side – Air Bag – Remove and Install (40 701 0)**Remove**

 **WARNING:** Wait at least 15 minutes after disconnecting the battery before disconnecting the electronic control module multiplug. For all other supplementary restraint system multiplugs wait two minutes. If these times are not observed there may be the possibility of accidentally deploying the air bag(s) and the pyrotechnic seat belt pre-tensioners.

 **WARNING:** Always work on the air bag module from the side. Always carry the module with the cover side uppermost and away from the body. Do not attempt to repair, open or apply power (multimeter) to the air bag module terminals.

 **CAUTION:** Disconnect the battery negative lead.

1. **Prise the air bag module cover out of the facia crash pad.**

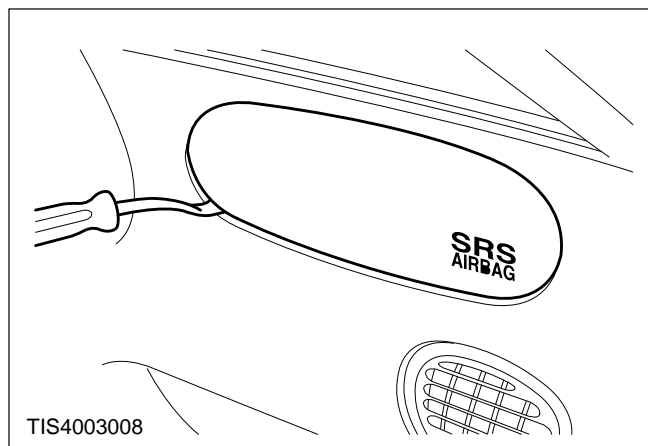

 **CAUTION:** The cover is attached to the facia crash pad.

2. **Place the cover to one side.**

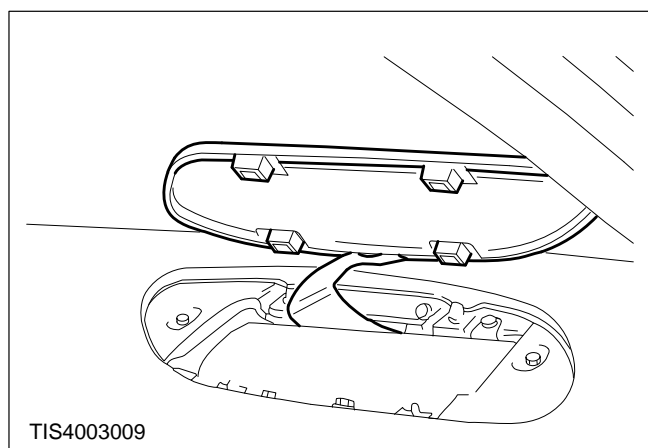

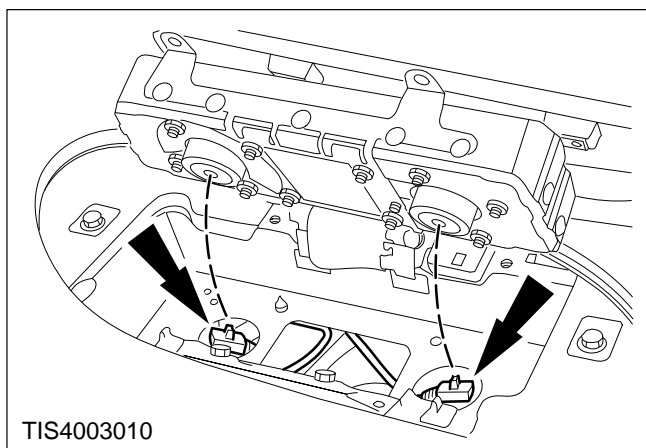

3. Working through the access panel in the glovebox, disconnect the air bag module multiplugs. (Shown removed for clarity).

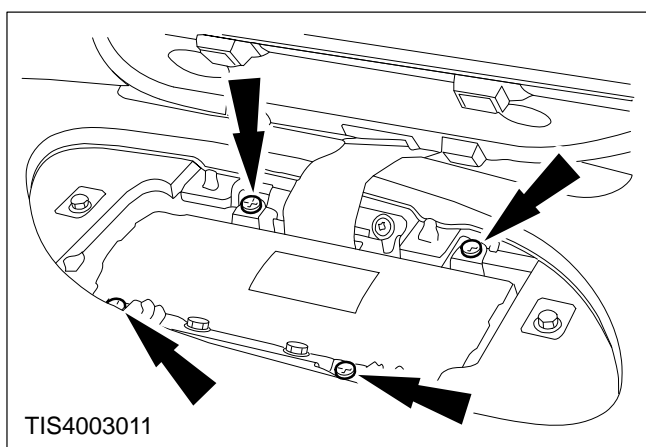

4. Remove the four retaining screws.

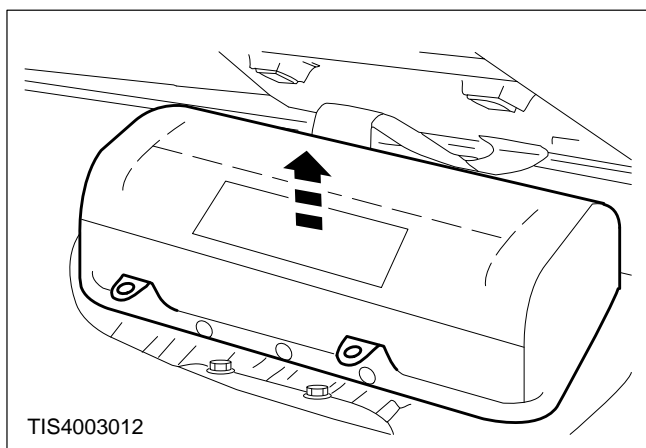

⚠ WARNING: Always carry the module with the cover side away from the body and stand it with the cover uppermost. Do not attempt to repair, open or apply electrical power to the module. Never use modules that are visibly damaged. Do not expose the module to heat sources in excess of 100°C.

5. Remove the air bag module from the vehicle.

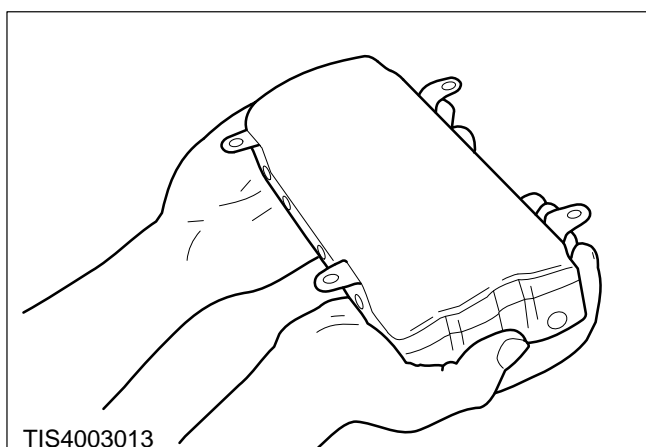

Install



WARNING: If the original air bag module has been deployed, carefully check the facia crash pad for signs of cracking, whitening (indicating that the area has been stressed) or distortion before installing a new air bag module. If any of these defects are present then a new facia crash pad must be fitted before the new air bag module is fitted. Failure to do so could result in unsatisfactory deployment of the air bag.

6. Refit the components in reverse order.