

## Motor – Seat Operating (High Series) – Remove and Install (33 784 0)

### Equipment

Terminal Repair Kit	FDEP 0472510
---------------------	--------------

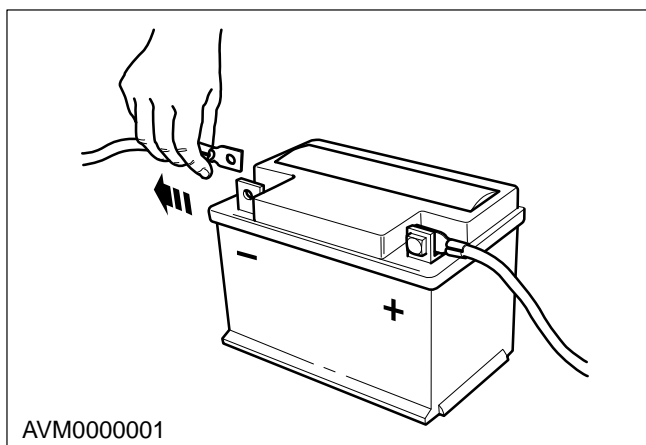

### Remove

1. Raise the seat
2. Disconnect the battery negative lead.

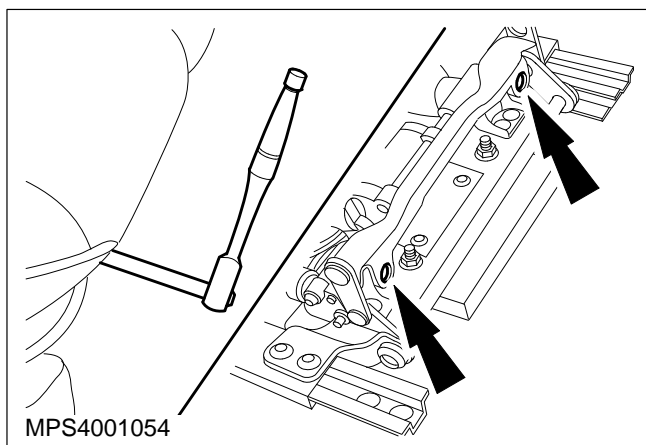

3. Remove the two bolts and tilt back the seat assembly.

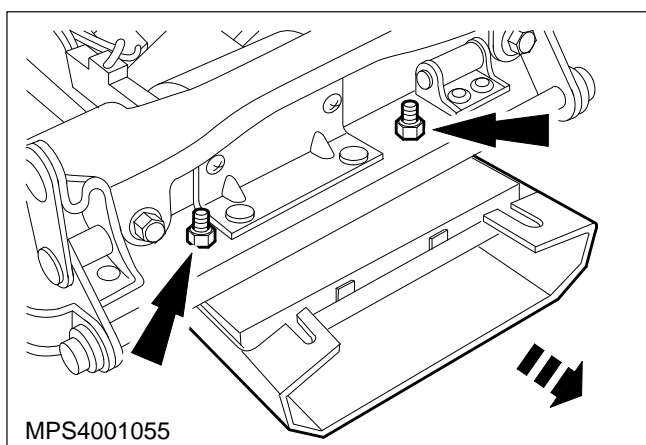

4. Detach the multiplex module (two nuts).

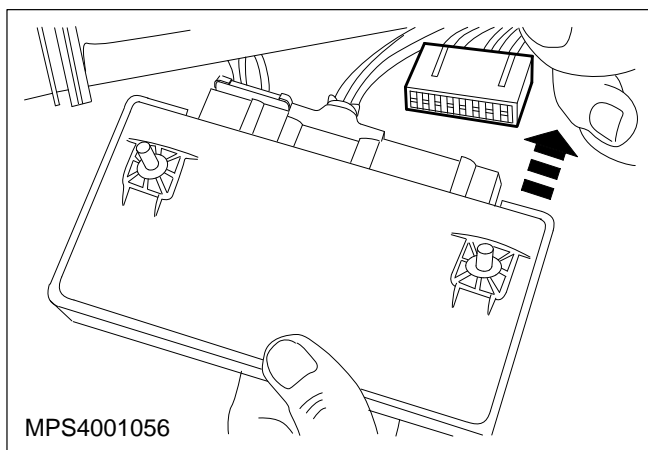

**5. Disconnect the multiplug.**

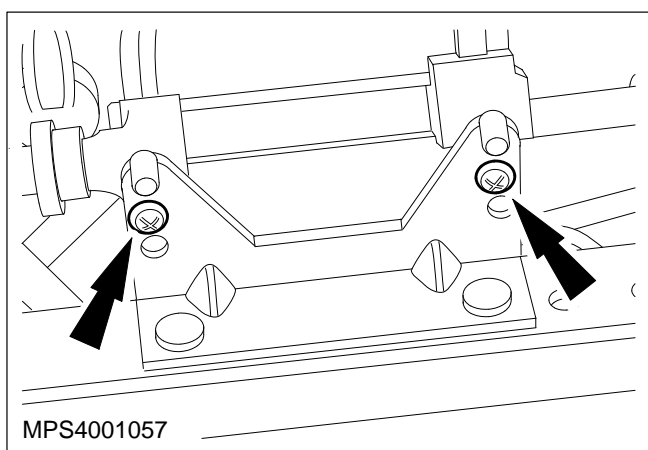

Forward/Backward Motor – Remove.

**6. Detach the motor (two screws).**

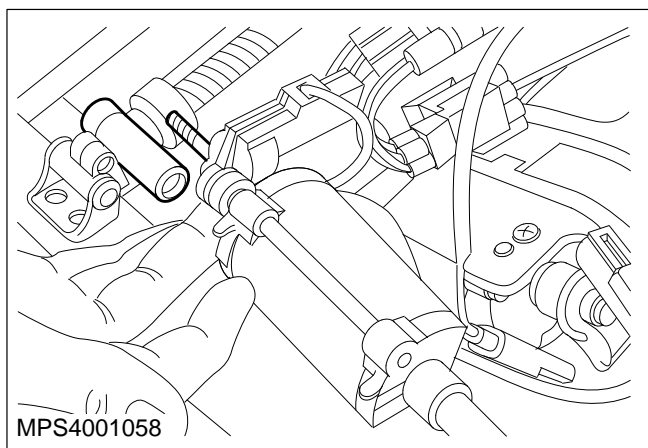

**7. Remove the drive cable.**

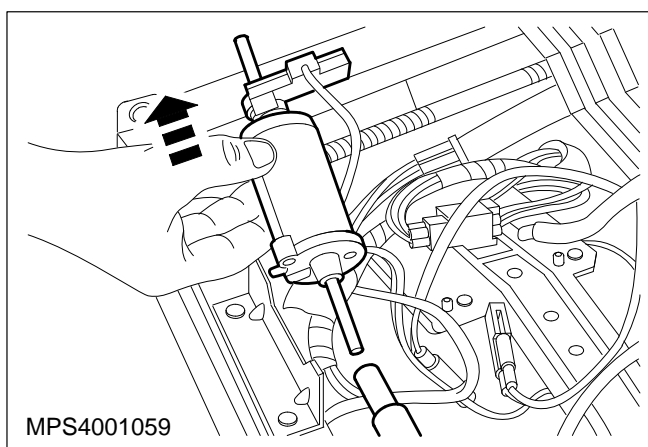

**8. Remove the motor.**

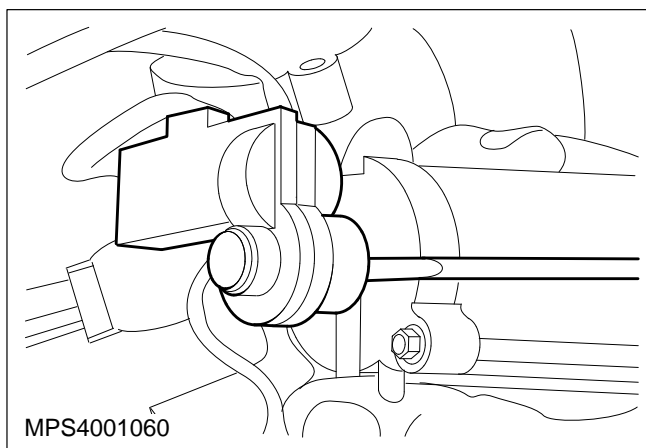

**9. Disconnect the rotation sensor unit.**

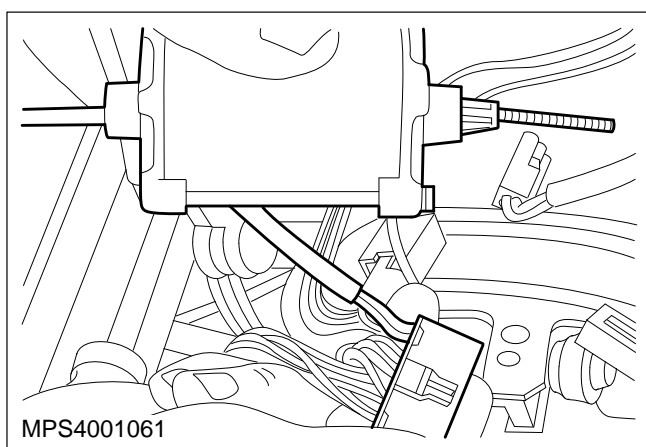

**10. Remove the two terminals from the multiplug.**

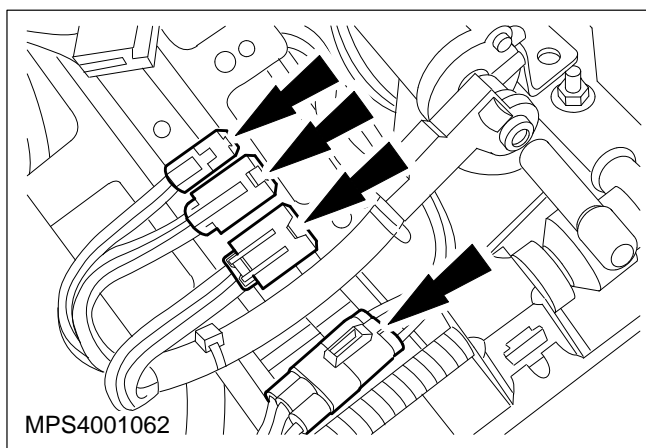

Front Riser Motor – Remove.

**11. Unclip the four multipliers.**

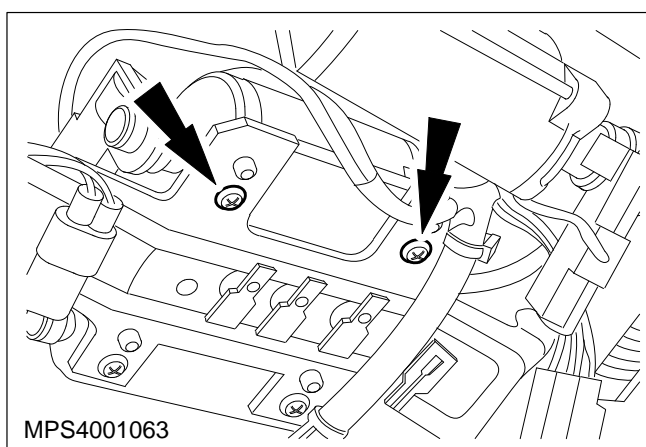

**12. Detach the motor (two screws).**

**13. Remove the motor (slide out towards the centre of the vehicle).**

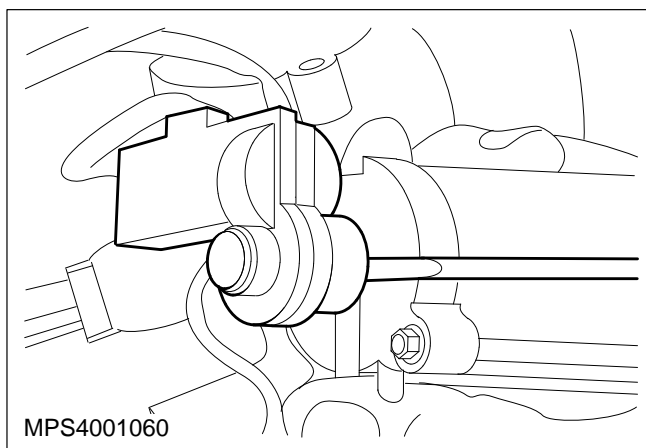

**14. Disconnect the rotation sensor unit.**

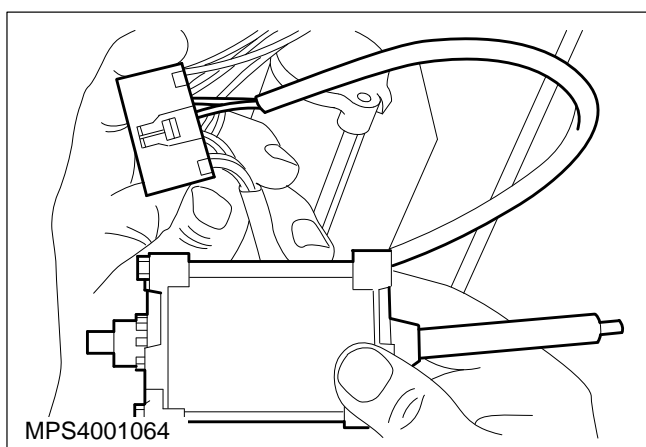

**15. Remove the two terminals from the multiplug.**

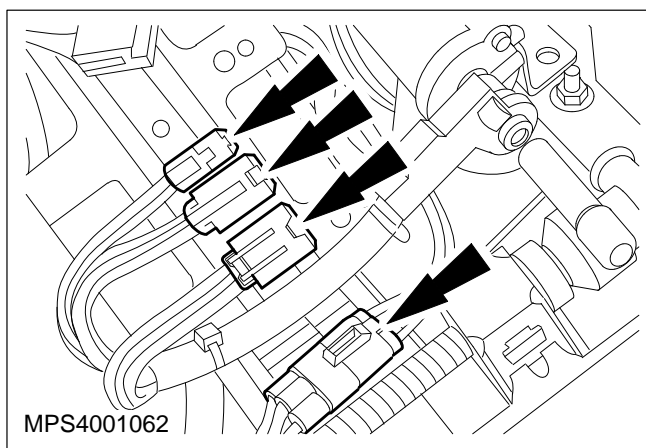

Rear Riser Motor – Remove.

**16. Unclip the four multiplugs.**

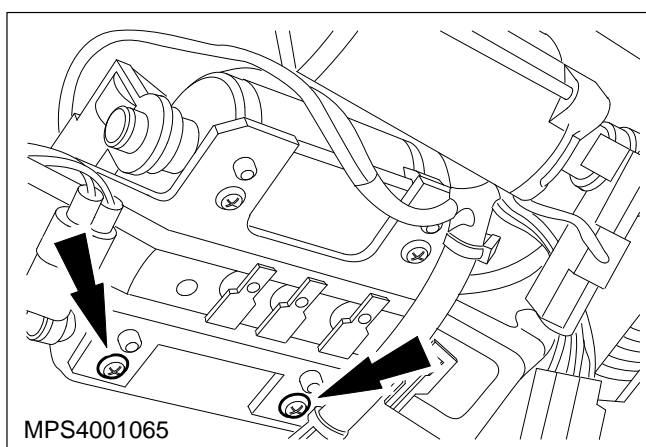

**17. Detach the motor (two screws).**

**18. Remove the motor (slide out towards the centre of the vehicle).**

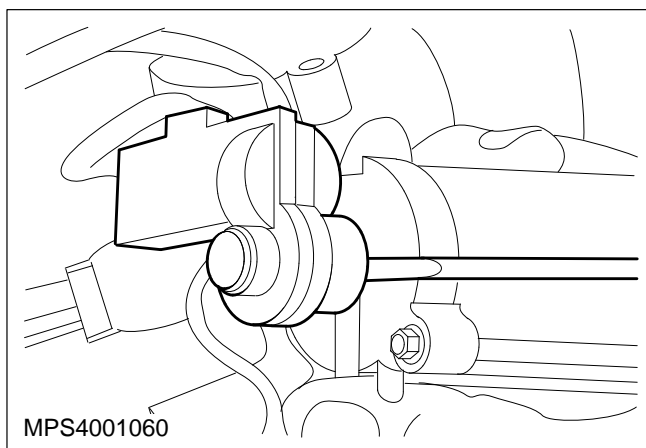

**19. Disconnect the rotation sensor unit.**

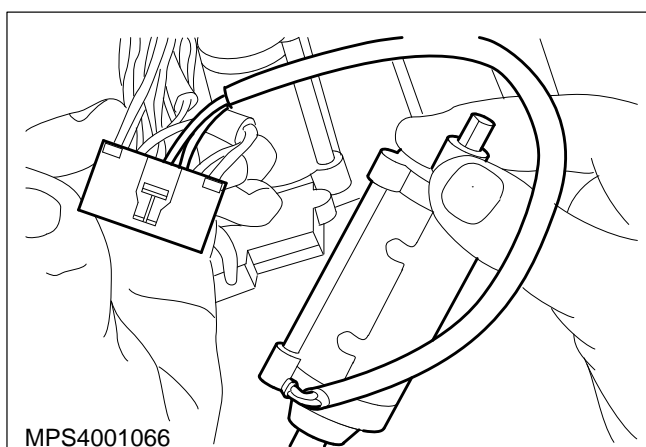

**20. Remove the two terminals from the multiplug.**

Install

**21. Refit the components in reverse order.**