

Panel – Door Trim – Front – Remove and Install (43 705 0)

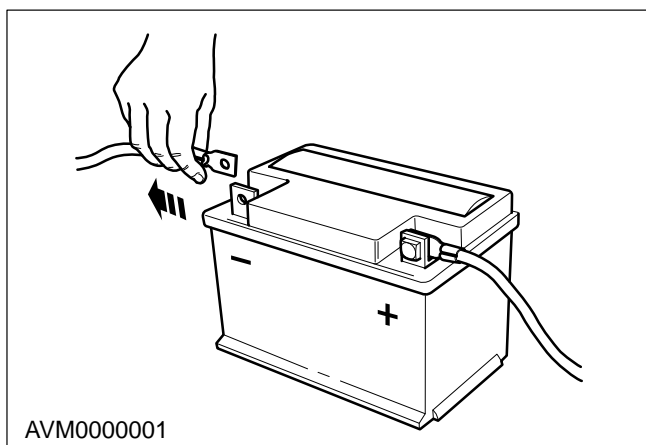

Remove

1. **Disconnect the battery negative lead.**

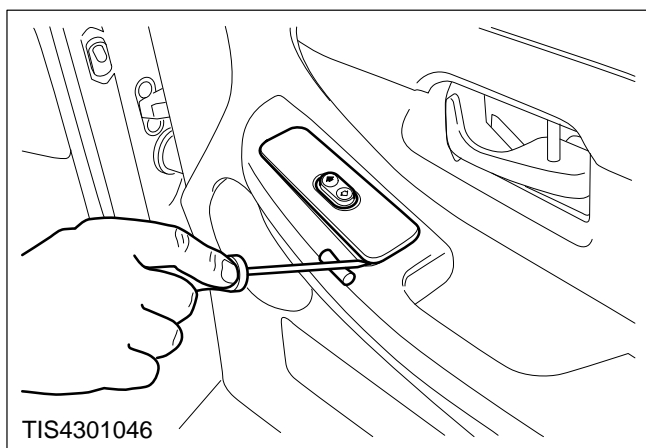

Vehicles equipped with power windows only

2. **Remove the window operating switch.**
 - Carefully prise out the switch.
 - Disconnect the multiplug.

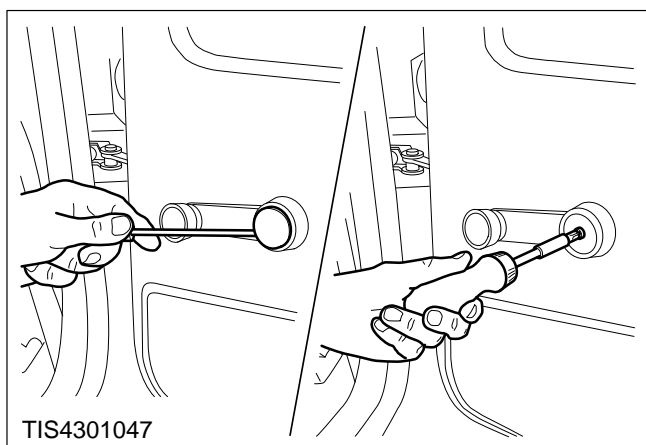

Handle – Door Window Regulator – Remove (43 716 0)

Vehicles fitted with manually operated windows only

3. **Remove the window winder handle.**

Prise out the centre bezel to reveal the screw.

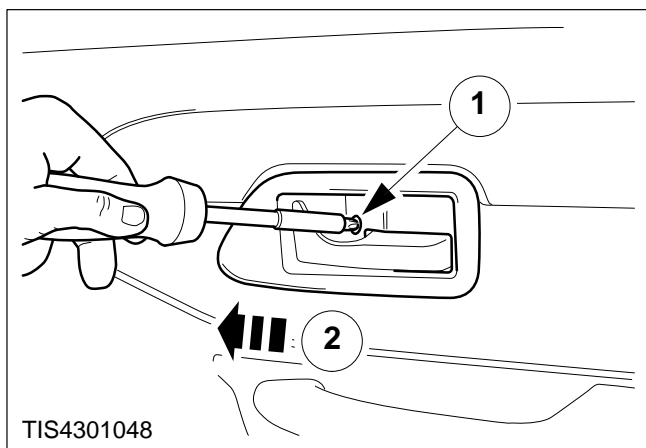

4. Remove the door latch bezel.

- 1 Remove the securing screw.
- 2 Disengage the clip.

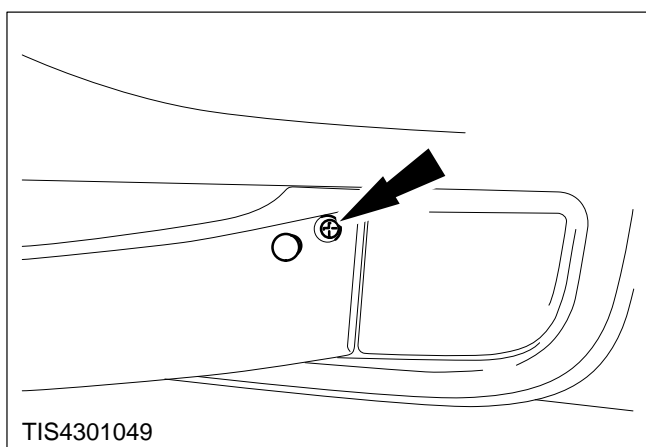

5. Remove the map pocket securing screws.

Pry out the caps to reveal the screws, one at the front and one at the rear.

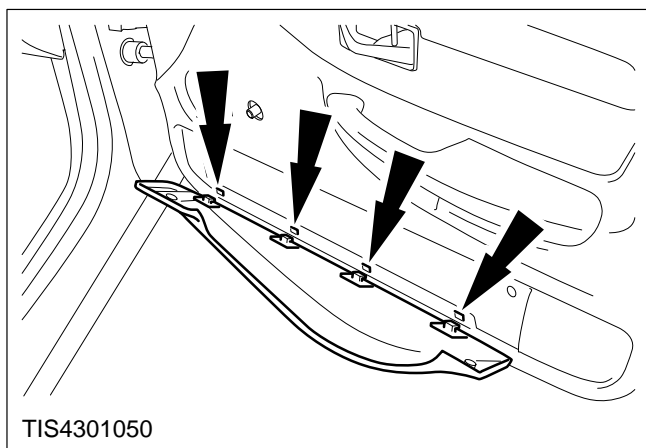

6. Remove the map pocket.

Four clips.

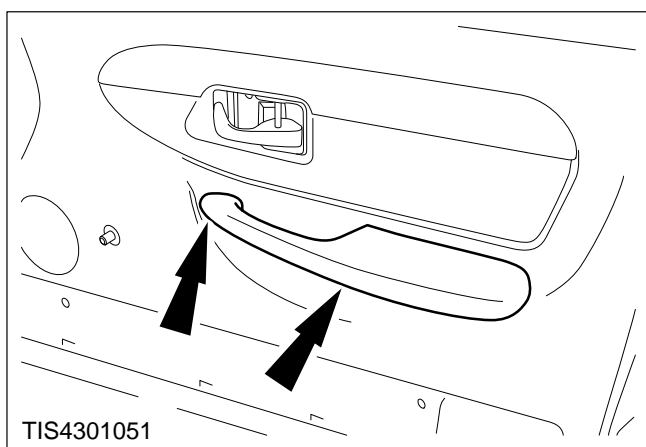

Handle – Door Pull – Remove (43 718 0)

7. Remove the door pull handle.

Two screws.

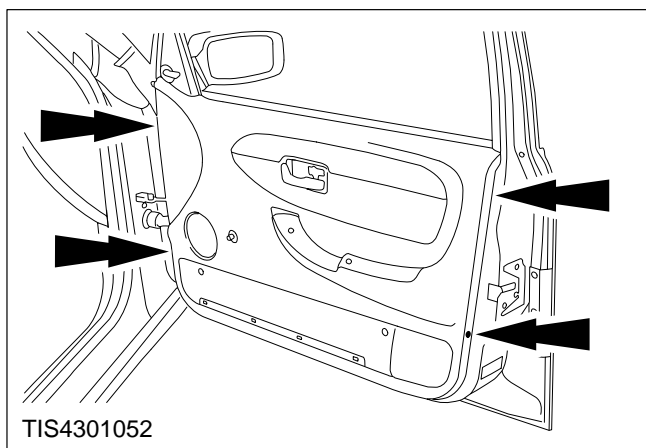
**8. Remove the trim.**

Disconnect the speaker multiplug.

Install**9. Refit the components in reverse order.**

Handle – Door Window Regulator –
Install – (43 716 0)

Handle – Door Pull – Install (43 718 0)